

Plan For Exterior A-frame Barn Owl Box

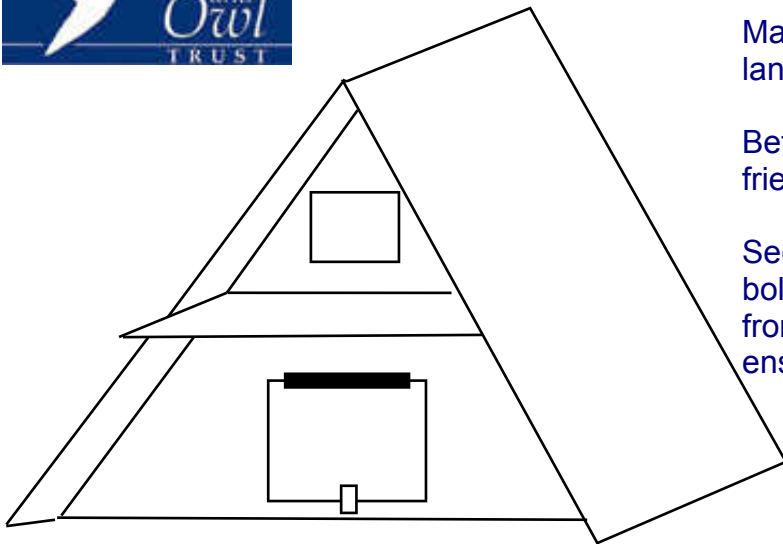

Material: 9mm exterior grade plywood except landing ledge and strengthening panel.

Before installation, treat with environmentally friendly wood preservative

Secure triangular shell to tree with 2 x coach bolts or similar strong fixing and then screw front panel c/w shelf to shell, ensuring shelf is secure.

Key Installation Notes:

- Install on tree in open farmland, isolated hedgerow or woodland edge.
- Ensure entrance hole is clearly visible
- Installing two boxes nearby to each other will accommodate male during breeding season

PANELS (Not to scale)

Base is slightly shorter than back/front to allow for airflow

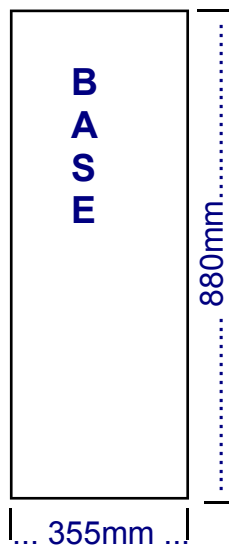
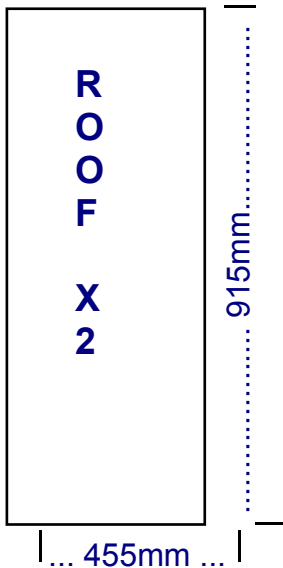

landing ledge made of 25mm softwood

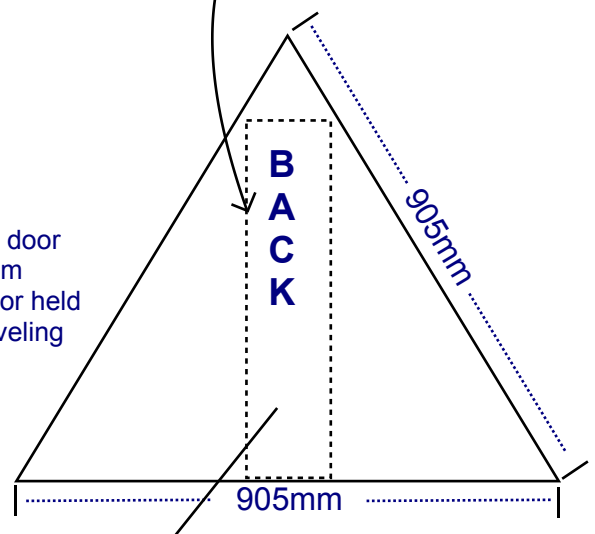
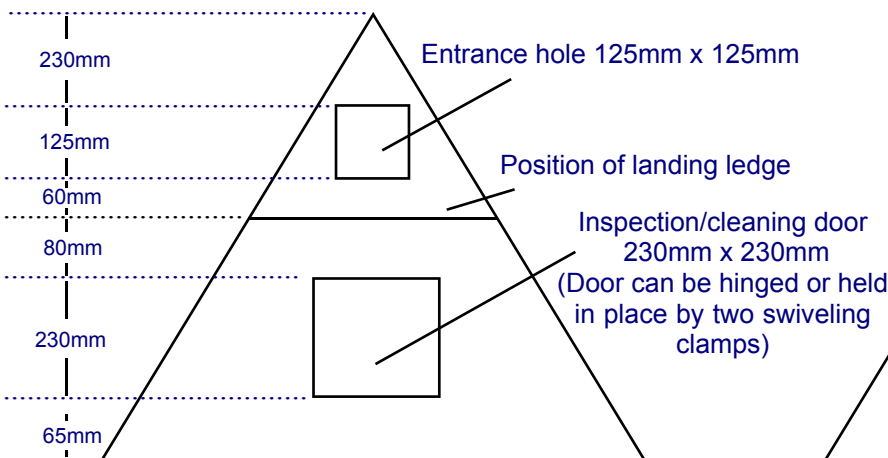
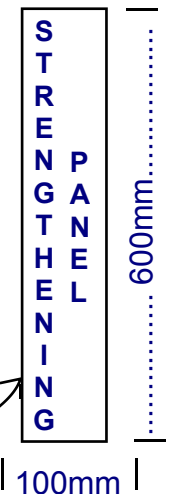
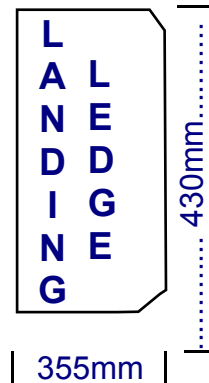

Box designs by Emma Hall & Keith Hall of Specialised Nestboxes

Position of back strengthening panel